

Thank you for choosing Cunningham as your *Clever Protective Cover* specialists

Step 1

- Fix panel in position with temporary fixings
- e.g. large screw

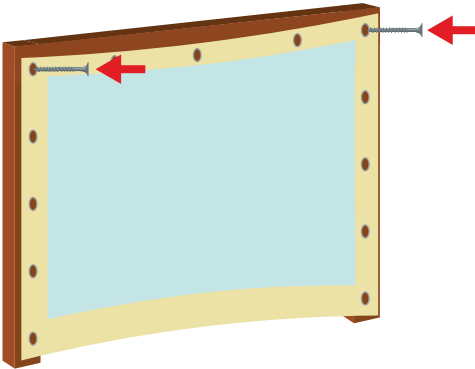

Step 2

- Mark out positions where turnbuttons will be fixed

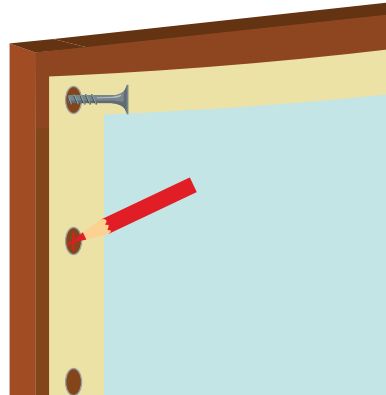

Step 3

- Remove panel and secure fixings in line with markings.
- Start with middle & corner eyelets as a guide, check panel is in correct position before proceeding with remainder of fixings.

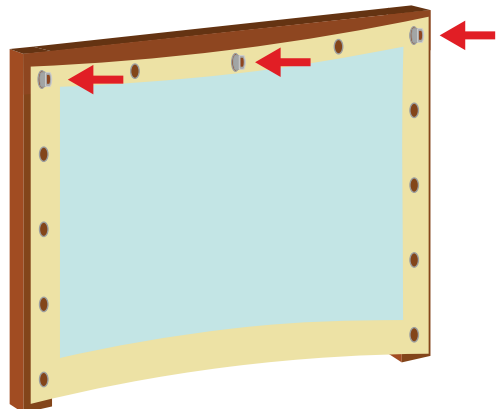
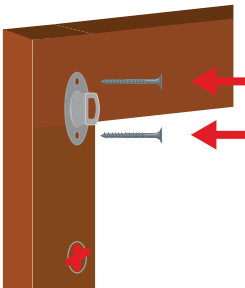

Step 4

- Place eyelet over turn-button and turn to secure in place

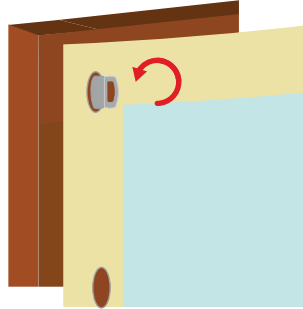
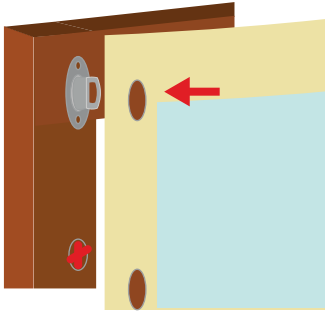

Initial Installation

We recommend your panels are kept rolled down for the first couple of weeks after installation. This allows the product to settle and straighten through its own weight.

General Maintenance

Windows can be cleaned with warm soapy water and a cloth/sponge. A power washer may also be used as long its from a distance of at least 1.5m.

Winter Maintenance

Keep the panels rolled down during winter, especially in temperatures below 5C. Keeping panels rolled up during colder temperatures can cause them damage.

Warnings

Sharp objects can scratch or otherwise damage the panels. Panels that come in contact with extreme heat e.g. fire, sparks or cigarettes can cause damage.

Strong Winds

In strong winds, ensure the panels are rolled down and securely fastened.

Rolling Up

When rolling your panels up, make sure they are completely dry and clean.

Roll Down at Night

Your panels should be rolled down every night to prevent shrinkage and discolouration from condensation.

Scan the QR code for our
YouTube Panel Fitting Video



Send a snap of your cover to
info@cunninghamcovers.ie

Thank you!

